

SOLUTIONS IN BUILDING AND INDUSTRIAL INSTALLATIONS SEALING SYSTEMS FOR MULTI-CABLE CABINET ENTRIES

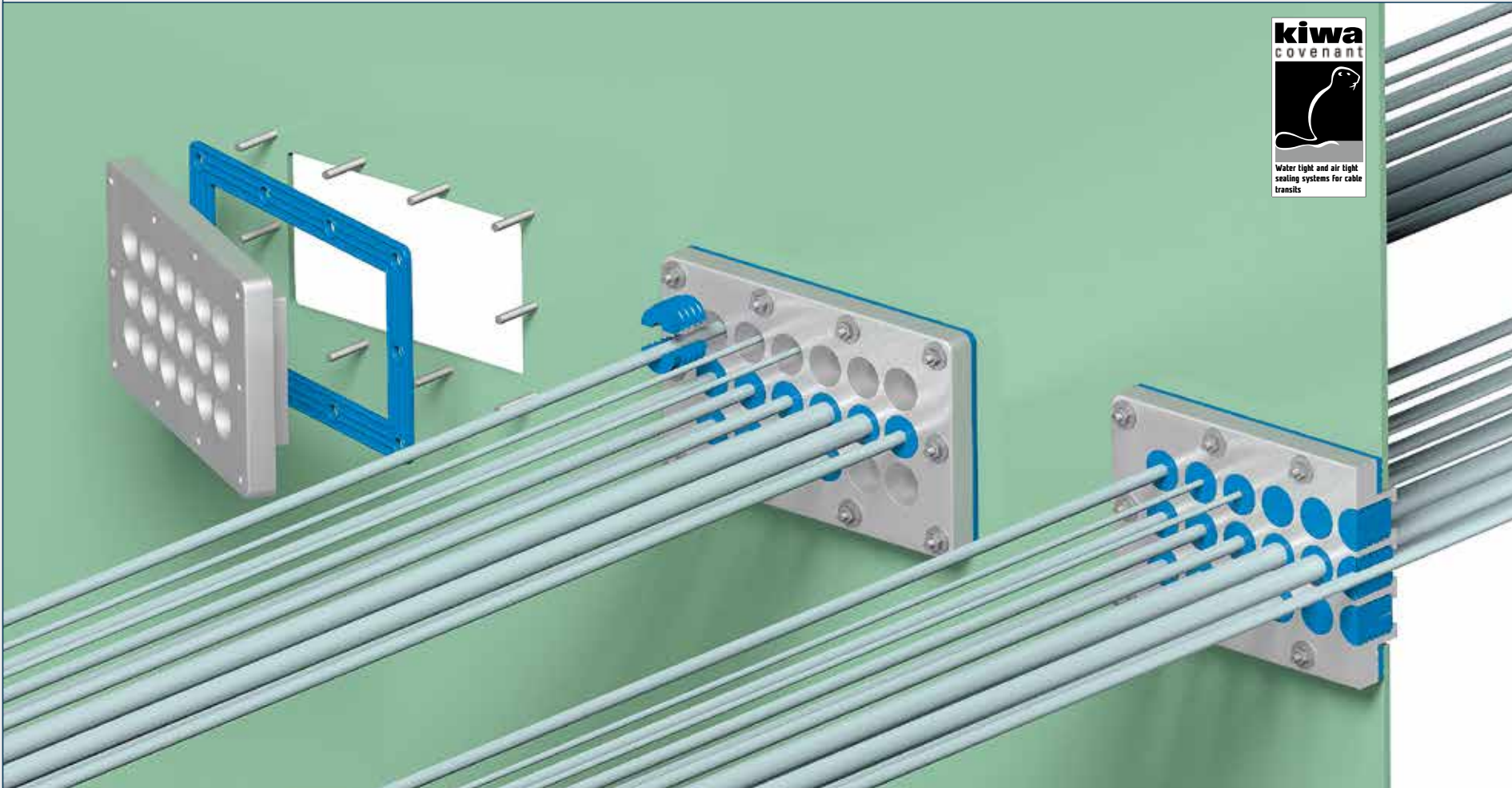

**SAFETY
SEALING
SYSTEMS**

GLANDMOD® modules - CET-A-SIL® sealing plugs - NOFIRNO® gaskets
The alternative for glands used for cable entries in electrical cabinets
water and gas tight - blast proof - IP rated
Modules made of HMPE plastic or aluminum - various configurations
Modules also available in fire resistant NOFIRNO® rubber

CET-A-SIL

NOFIRNO

**GLANDMOD - MULTI-GLAND SYSTEM
MULTI-MODULES - NOFIRNO GASKETS - CET-A-SIL PLUGS**

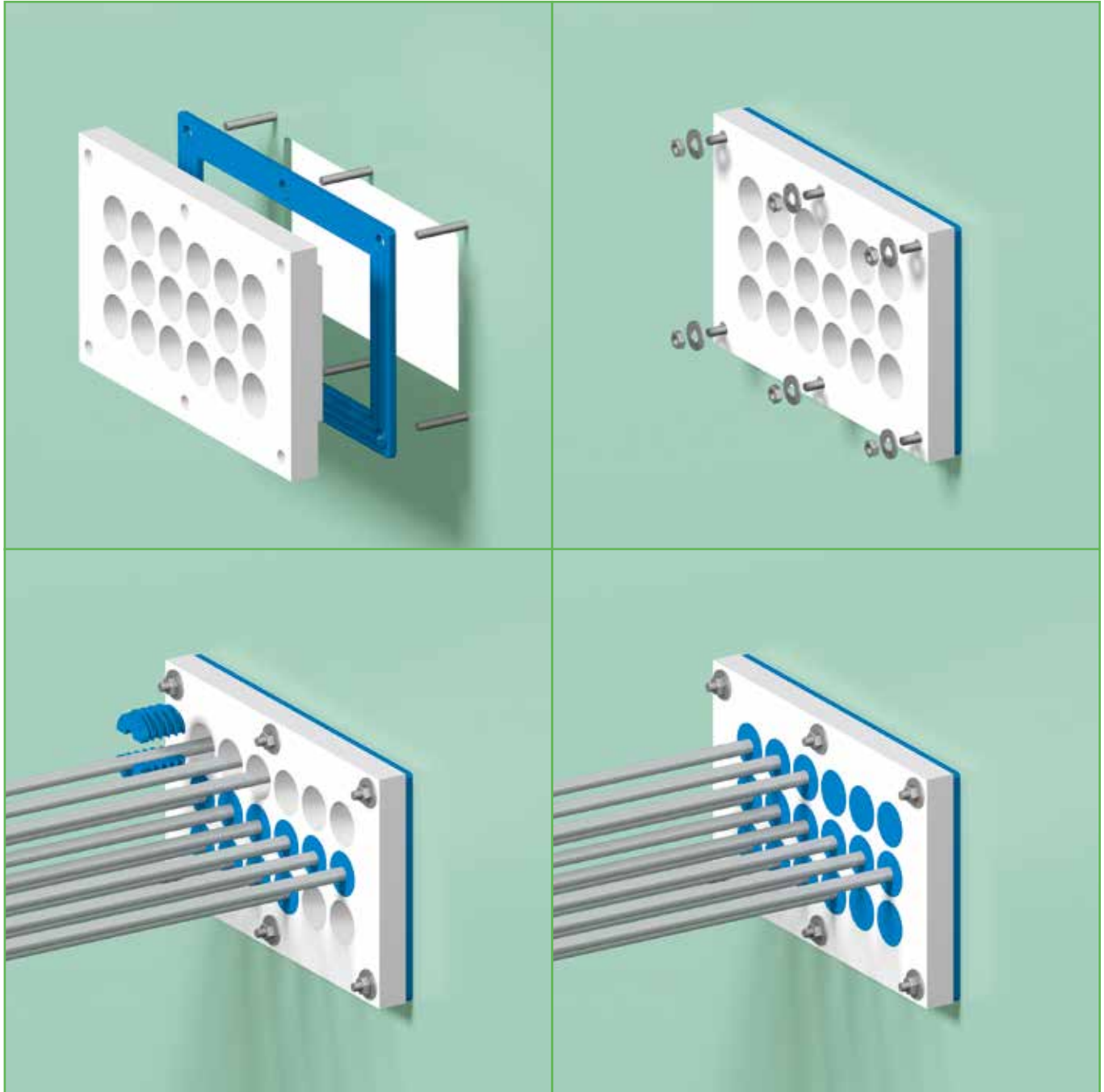

GLANDMOD - MULTI-GLAND SYSTEM
effective alternative for cable gland systems
plugs/gasket made of NOFIRNO® rubber -
body of HMPE plastic
suitable for IP 68 rated equipment - up to 4 meter
water column tight - various configurations



GLANDMOD - MULTI-GLAND SYSTEM MULTI-MODULES - NOFIRNO GASKETS - CET-A-SIL PLUGS

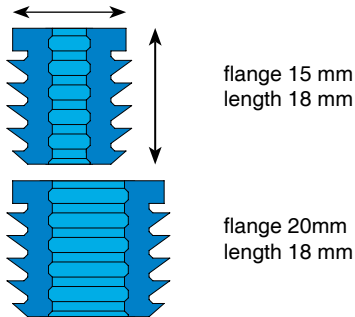

type	cable diameter	art. no.
15/0	blind	46.0100
15/4	3.7-4.7	46.0104
15/5	4.7-5.7	46.0105
15/6	5.7-6.7	46.0106
15/7	6.7-7.7	46.0107

CET-A-SIL SERIES 15

type	cable diameter	art. no.
20/0	blind	46.0200
20/4	3.7-4.7	46.0204
20/5	4.7-5.7	46.0205
20/6	5.7-6.7	46.0206
20/7	6.7-7.7	46.0207
20/8	7.7-8.7	46.0208
20/9	8.7-9.7	46.0209
20/10	9.7-10.7	46.0210

CET-A-SIL SERIES 20

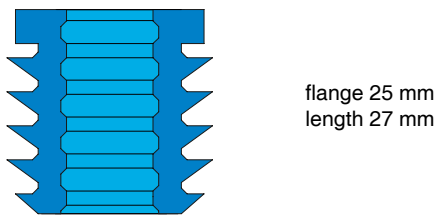

type	cable diameter	art. no.
25/0	blind	46.0300
25/8	7.7-8.7	46.0308
25/9	8.7-9.7	46.0309
25/10	9.7-10.7	46.0310
25/11	10.7-11.7	46.0311
25/12	11.7-12.7	46.0312
25/13	12.7-13.7	46.0313
25/14	13.7-14.7	46.0314

CET-A-SIL SERIES 25

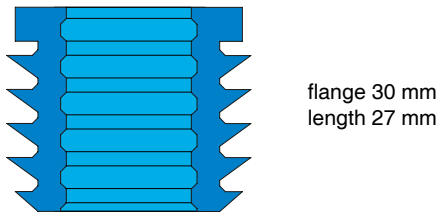

type	cable diameter	art. no.
30/0	blind	46.0400
30/10	9.7-10.7	46.0410
30/11	10.7-11.7	46.0411
30/12	11.7-12.7	46.0412
30/13	12.7-13.7	46.0413
30/14	13.7-14.7	46.0414
30/15	14.7-15.7	46.0415
30/16	15.7-16.7	46.0416
30/17	16.7-17.7	46.0417

CET-A-SIL SERIES 30

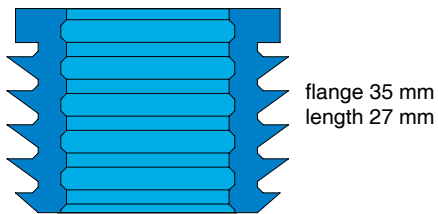

type	cable diameter	art. no.
35/0	blind	46.0500
35/15	14.7-15.7	46.0515
35/16	15.7-16.7	46.0516
35/17	16.7-17.7	46.0517
35/18	17.7-18.7	46.0518
35/19	18.7-19.7	46.0519
35/20	19.7-20.7	46.0520
35/21	20.7-21.7	46.0521
35/22	21.7-22.7	46.0522

CET-A-SIL SERIES 35

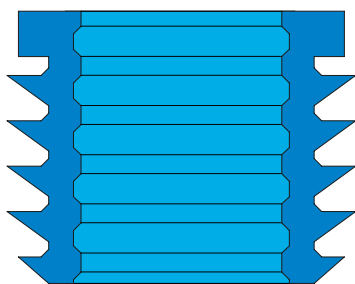

type	cable diameter	art. no.
43/0	blind	46.0600
43/20	19.7-20.7	46.0620
43/21	20.7-21.7	46.0621
43/22	21.7-22.7	46.0622
43/23	22.7-23.7	46.0623
43/24	23.7-24.7	46.0624
43/25	24.7-25.7	46.0625
43/26	25.7-26.7	46.0626
43/27	26.7-27.7	46.0627
43/28	27.7-28.7	46.0628
43/29	28.7-29.7	46.0629

CET-A-SIL SERIES 43

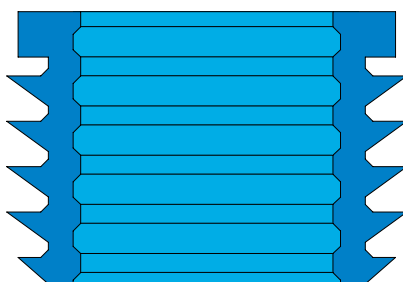

type	cable diameter	art. no.
50/0	blind	46.0700
50/25	24.7-25.7	46.0725
50/26	25.7-26.7	46.0726
50/27	26.7-27.7	46.0727
50/28	27.7-28.7	46.0728
50/29	28.7-29.7	46.0729
50/30	29.7-30.7	46.0730
50/31	30.7-31.7	46.0731
50/32	31.7-32.7	46.0732
50/33	32.7-33.7	46.0733
50/34	33.7-34.7	46.0734

CET-A-SIL SERIES 50

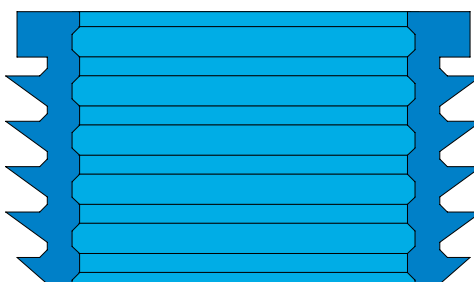

60/0	blind	46.0800
60/29	28.7-29.7	46.0829
60/30	29.7-30.7	46.0830
60/31	30.7-31.7	46.0831
60/32	31.7-32.7	46.0832
60/33	32.7-33.7	46.0833
60/34	33.7-34.7	46.0834
60/35	34.7-35.7	46.0835
60/36	35.7-36.7	46.0836
60/37	36.7-37.7	46.0837
60/38	37.7-38.7	46.0838
60/39	38.7-39.7	46.0839
60/40	39.7-40.7	46.0840

CET-A-SIL SERIES 60

flange 43 mm
length 36 mm

flange 50 mm
length 36 mm

flange 60 mm
length 36 mm

GLANDMOD - MULTI-GLAND SYSTEM MULTI-MODULES - NOFIRNO GASKETS - CET-A-SIL PLUGS

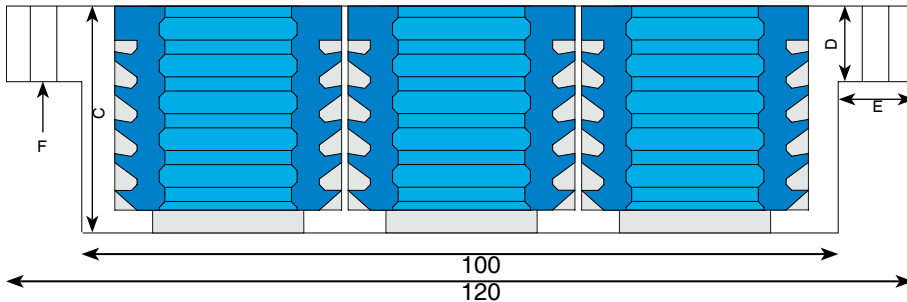

GLANDMOD SERIES 01:
outer dimensions 120x75 mm
recessed dimensions 100x55 mm

TYPE	A	B	C	D	E	F	art. no.
14x15	15	10	20	10	10	M4	60.9300
8x20	20	15	20	10	10	M4	60.9301
5x25	25	17.5	30	10	10	M4	60.9302
3x30	30	20	30	10	10	M4	60.9303

TYPE	conduit openings	plug series	cable size
14x15	14	15	3.7-7.7
8x20	8	20	3.7-9.7
5x25	5	25	7.7-14.7
3x30	3	30	9.7-17.7

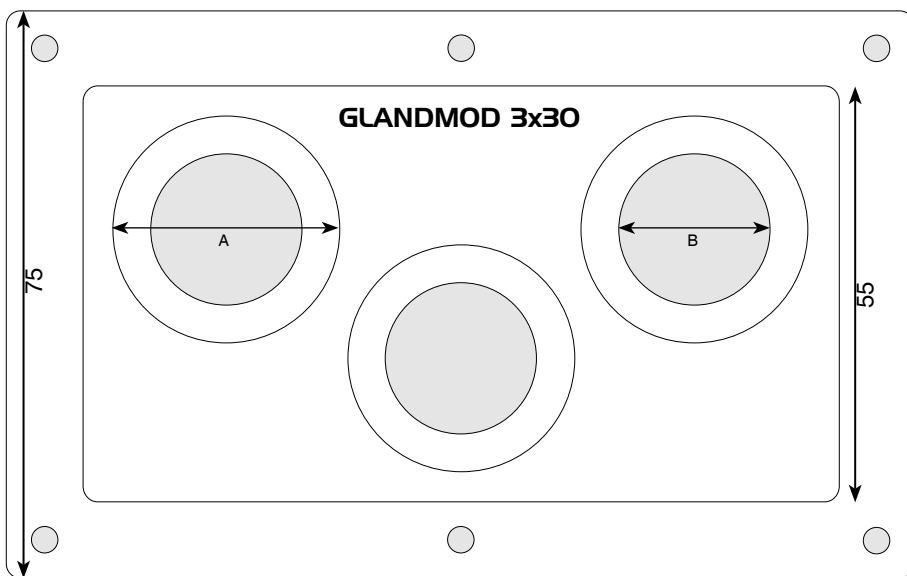

GLANDMOD SERIES 02:
outer dimensions 230x130 mm
recessed dimensions 200x100 mm

TYPE	A	B	C	D	E	F	art. no.
18x30	30	20	30	10	15	M6	60.9310
11x35	35	25	30	10	15	M6	60.9311
8x43	43	33	40	10	15	M6	60.9312
5x50	50	40	40	10	15	M6	60.9313

TYPE	conduit openings	plug series	cable size
18x30	18	30	9.7-17.7
11x35	11	35	14.7-22.7
8x43	8	43	19.7-28.7
5x50	5	50	24.7-34.7

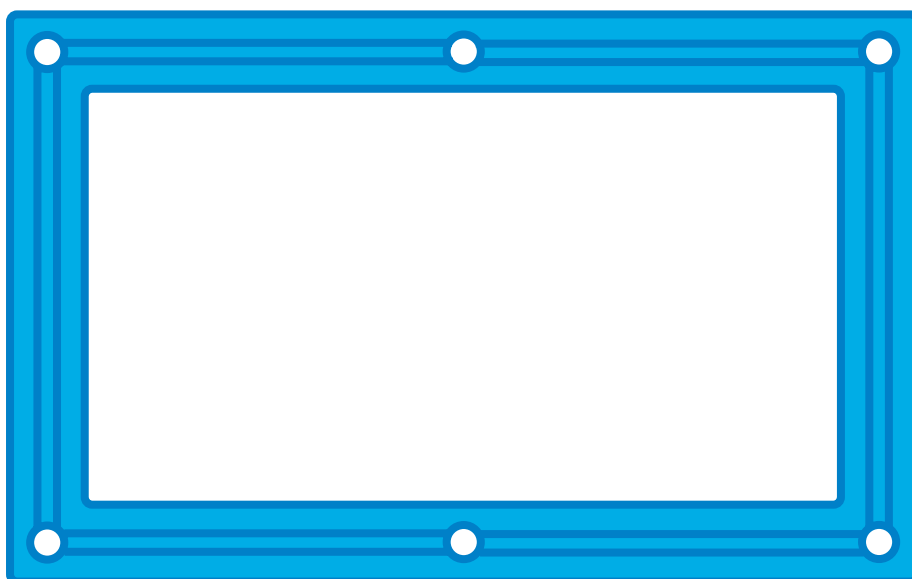

NOFIRNO GASKET SERIES 01
profiled, thickness overall 5 mm,
width 10 mm
dimensions outside 120x75 mm
dimensions inside 100x55 mm
art. nr. 51.9301

NOFIRNO GASKET SERIES 02
profiled, thickness overall 5 mm,
width 15 mm
dimensions outside 230x130 mm
dimensions inside 200x100 mm
art. nr. 51.9302

Note: the functionality with regard to tightness of the multi-gland system can be guaranteed only by application of the CET-A-SIL plugs in GLANDMOD modules. Application of CET-A-SIL plugs cannot be guaranteed in other conduit systems. Two standard series of the GLANDMOD modules are available. Ask for the drawings of the GLANDMOD modules. On request modules with various hole configurations can be made to size. The largest one so far made is a module 565 x 240 mm with 24 conduit openings 50 mm. For special sizes, please contact our sales department.

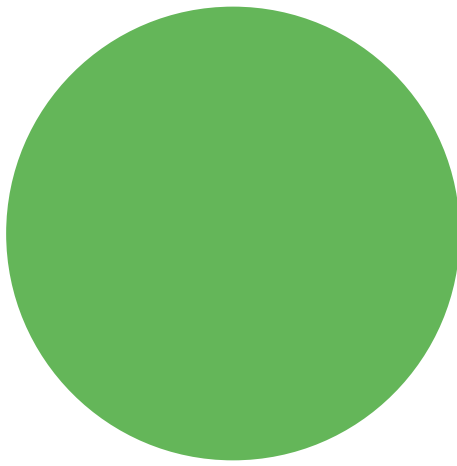

WE CARE

**BEELE ENGINEERING:
A COMPANY DEDICATED TO SAFETY
FOR OVER 40 YEARS**



BEELE Engineering bv - CSD International bv
Beunkdijk 11 - 7122 NZ AALTEN - THE NETHERLANDS
Tel. +31 543 461629 - Fax +31 543 461786 - E-mail: info@beele.com
**Websites: <http://www.beele.com> (and/or www.actifoam.com, www.firsto.com, www.nofirno.com,
www.rise-systems.com, www.rise-nofirno.com, www.riswat.com and www.slipsil.com)**